

**Cedar Chase  
Weatherboard Replacement  
Drawings**

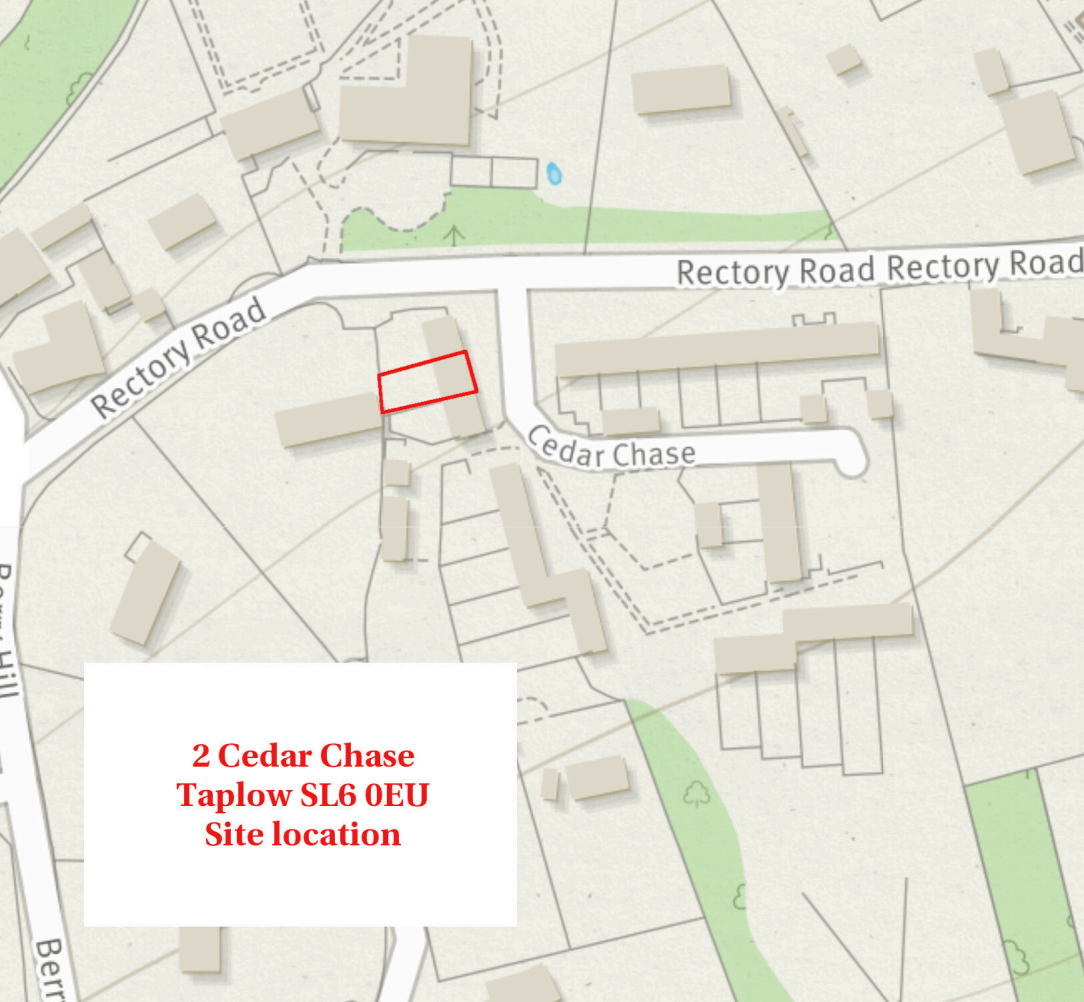

**2 Cedar Chase  
Taplow SL6 OEU  
Site location**

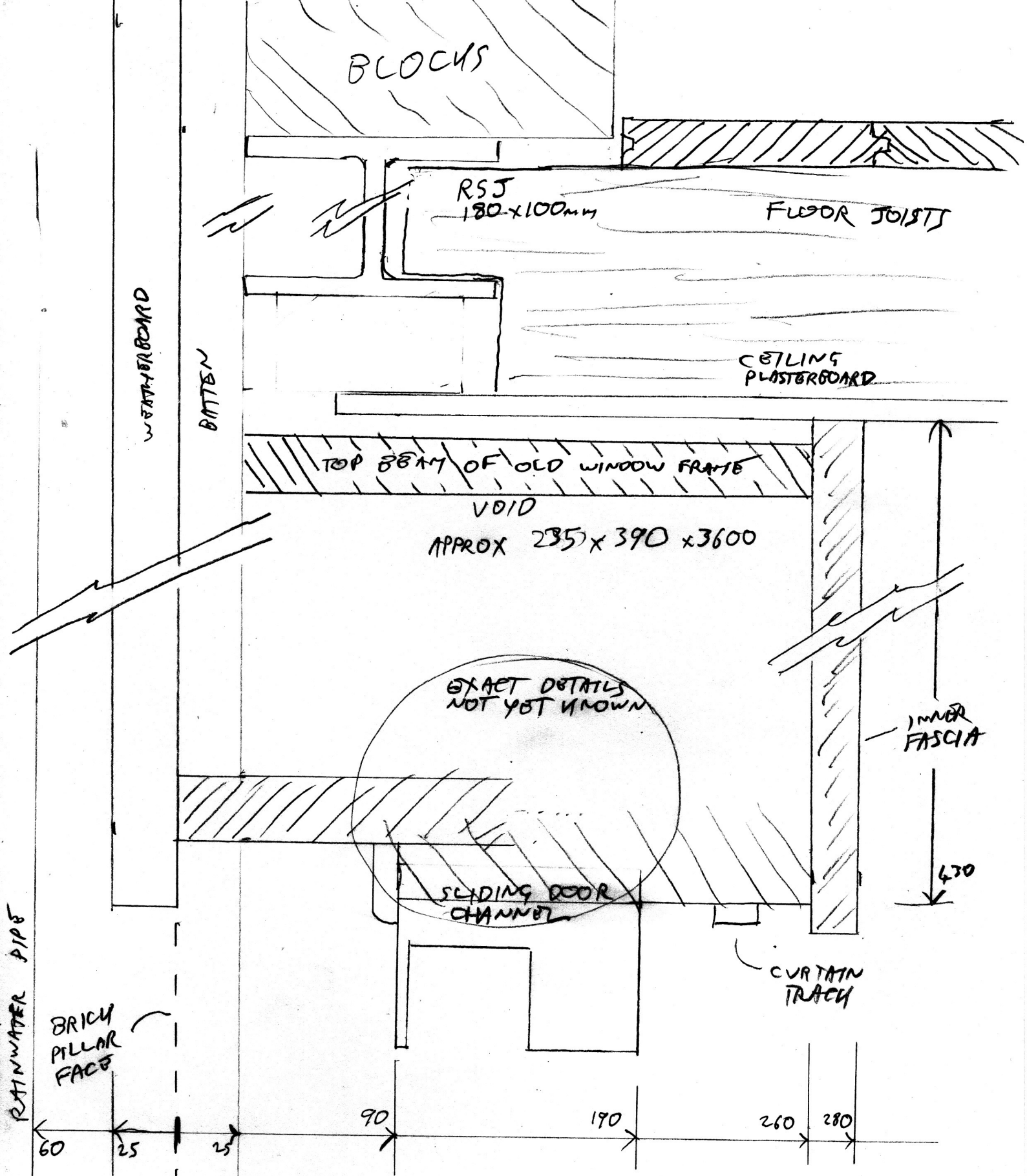

CEDAR CHASE

CROSS-SECTION OF AREA ABOVE  
LARGE LIVING-ROOM WINDOW  
- EXISTING

A 8/10/2019

UPDATED 26/1/2024

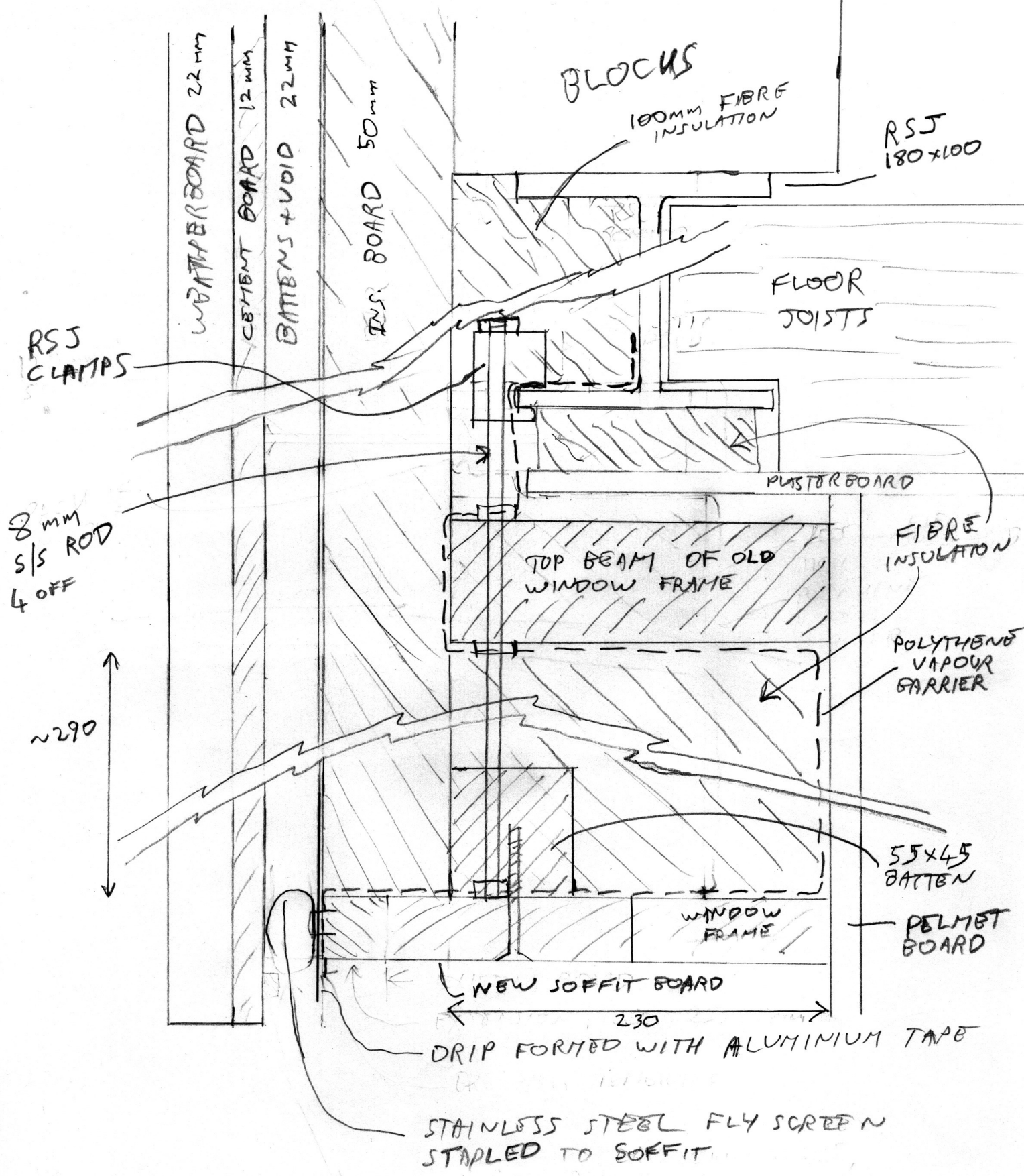

CEDAR CHASE  
 CROSS SECTION ABOVE LIVING-RM WINDOWS  
 - PROPOSED INSULATION  
 #26/1/2021  
 VERSION B



CEDAR CHUSE WEATHERBOARD REPLACEMENT  
PLAN VIEW  
A 26/1/2020

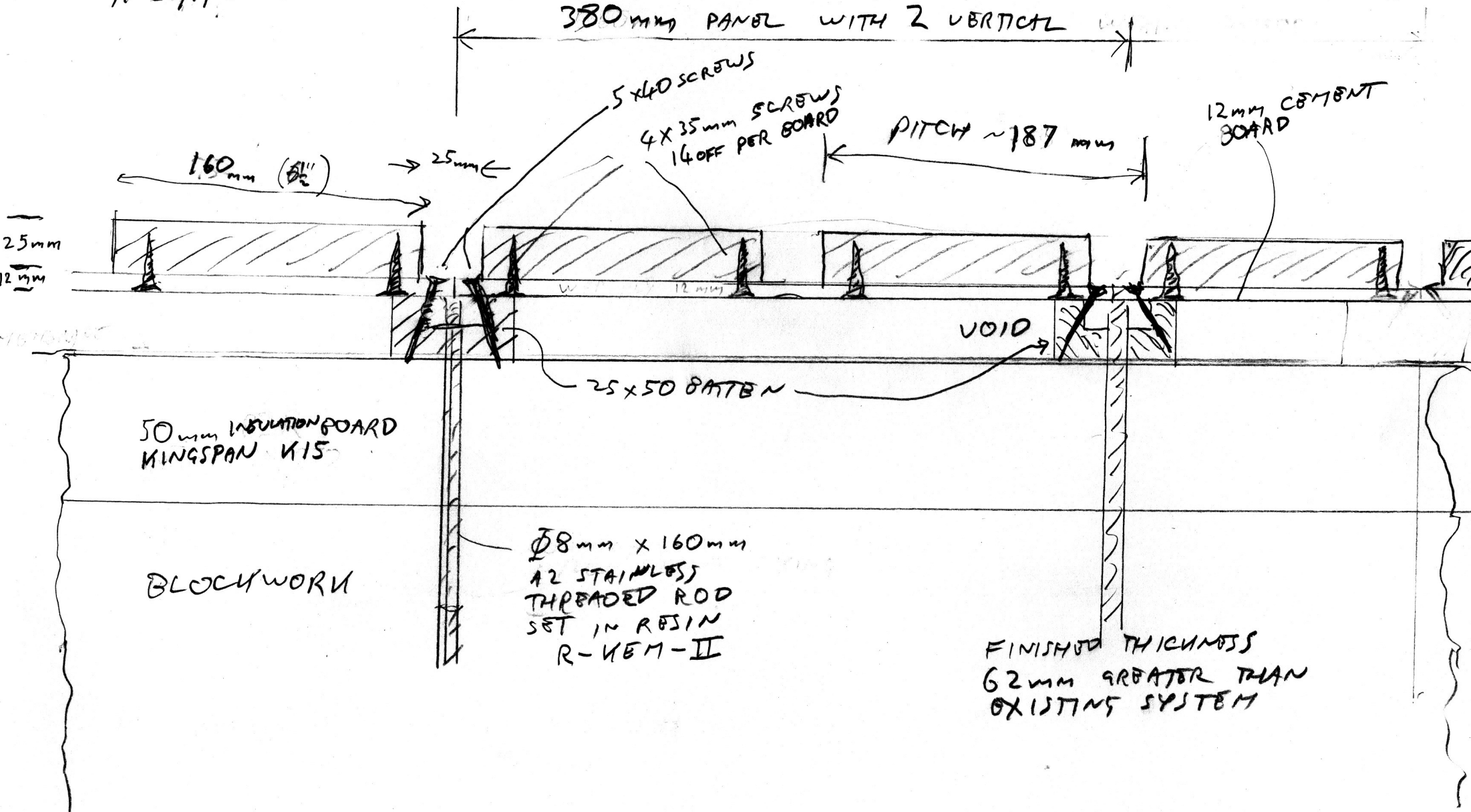

CEDAR CHASE  
 WEATHERBOARD REPLACEMENT  
 DETAILS OF TOP SECTION  
 AND ROOF  
 A 26/1/2021  
 VERSION F

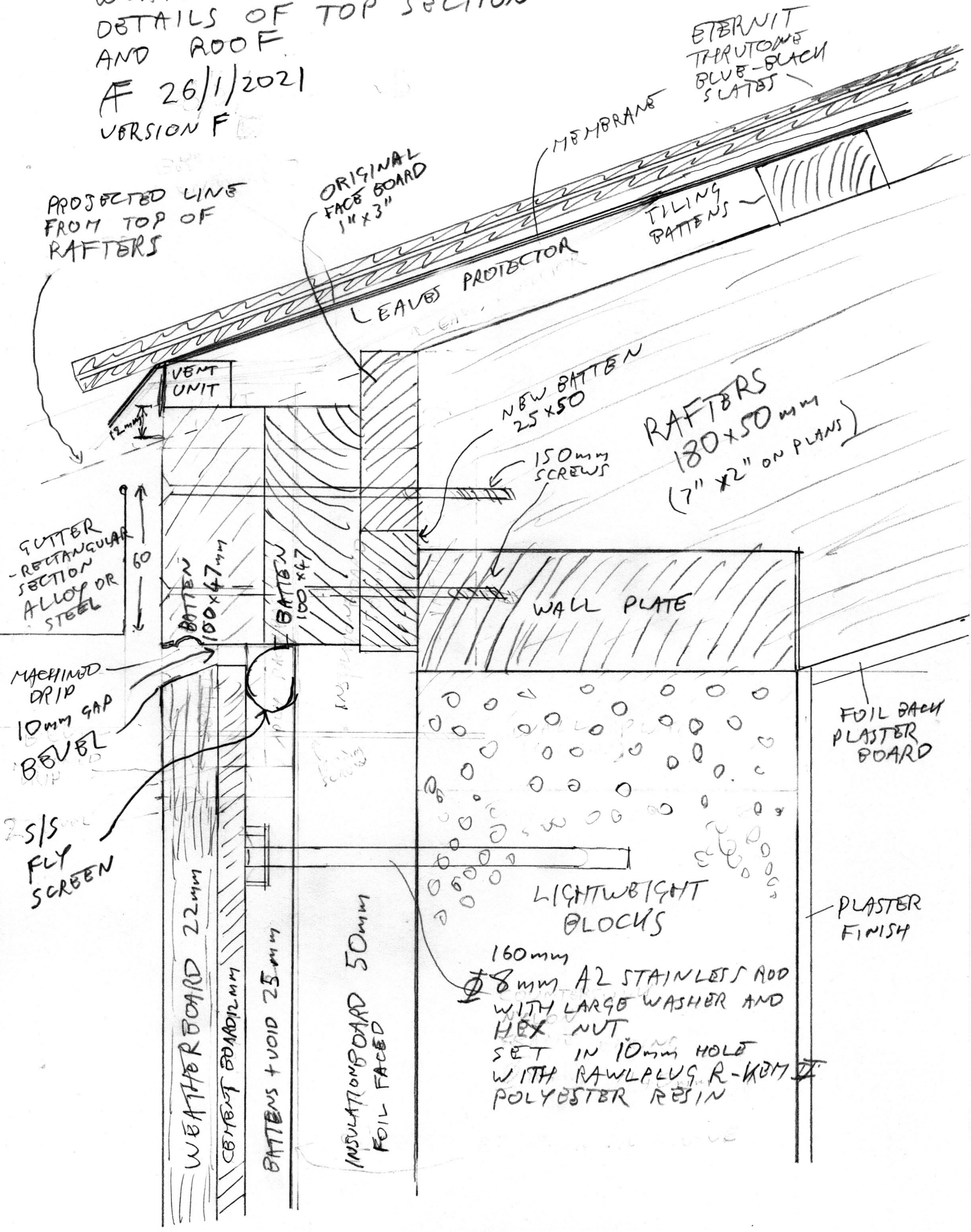

ETERNIT  
THRU TOMS  
BLUE-BLACK  
SLATES

PROJECTED LINE  
FROM TOP OF  
RAFTERS

ORIGINAL  
FACE BOARD  
1 1/4 x 3"

MEMBRANE

TILING  
BATTENS

LEAFLET PROTECTOR

VENT  
UNIT

NEW BATTEN  
25 x 50

RAFTERS  
180 x 50 mm  
(7" x 2" on PLANS)

150mm  
SCREWS

GUTTER  
RECTANGULAR  
SECTION  
ALLOY OR  
STEEL

60

BATTEN  
100 x 47 mm

BATTEN  
100 x 47

WALL PLATE

MACHINED  
DRIP  
10mm GAP  
BEVEL

25/S  
FLY  
SCREEN

FOIL BACK  
PLASTER  
BOARD

WEATHERBOARD 22mm

CEMENT BOARD 12mm

BATTENS + VOID 25mm

INSULATION BOARD 50mm  
FOIL FACED

LIGHTWEIGHT  
BLOCKS

PLASTER  
FINISH

160mm  
Ø8mm A2 STAINLESS ROD  
WITH LARGE WASHER AND  
HEX NUT  
SET IN 10mm HOLE  
WITH RAWLPLUG R-KOM  
POLYESTER RESIN

CEDAR CHASE  
 WEATHERBOARD  
 UNIT  
 VERSION E  
 A 26/1/2021

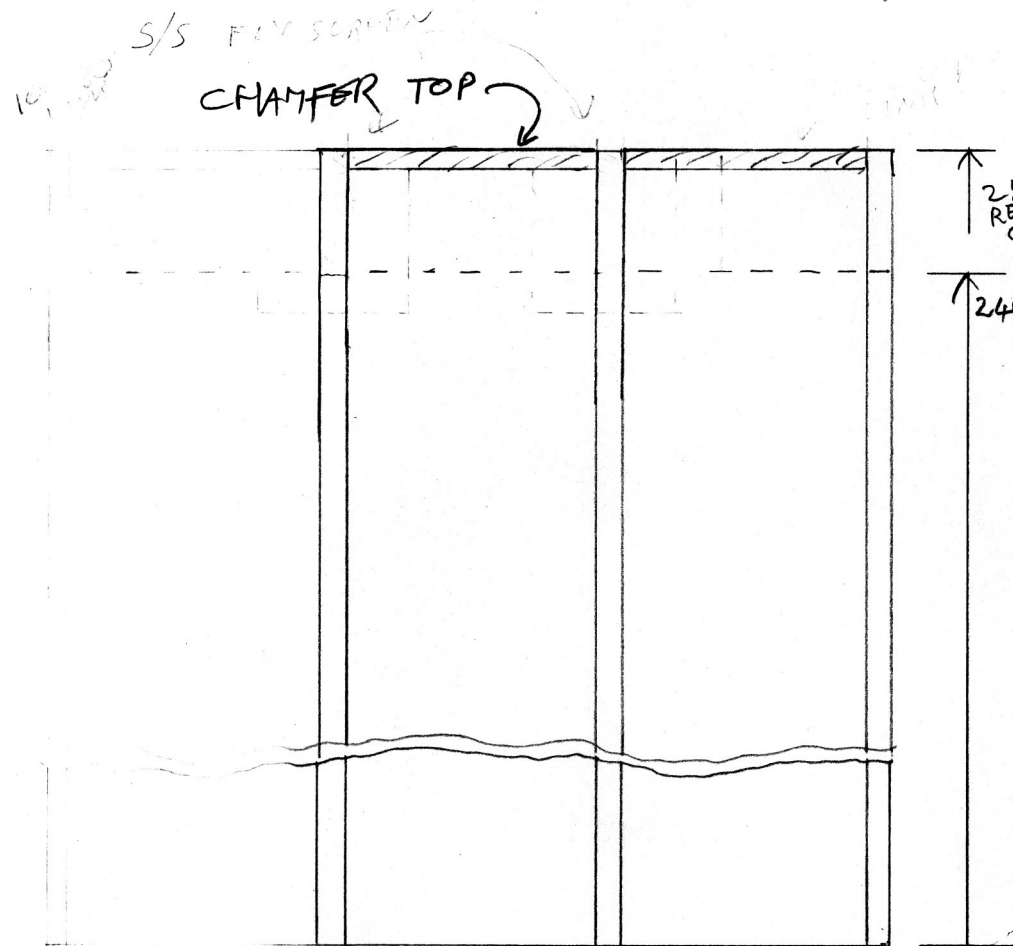
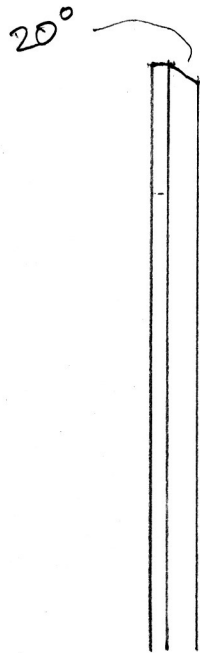

FULL-HEIGHT UNIT  
 WITH 2 BOARDS  
 WEIGHTS ~ 30kg

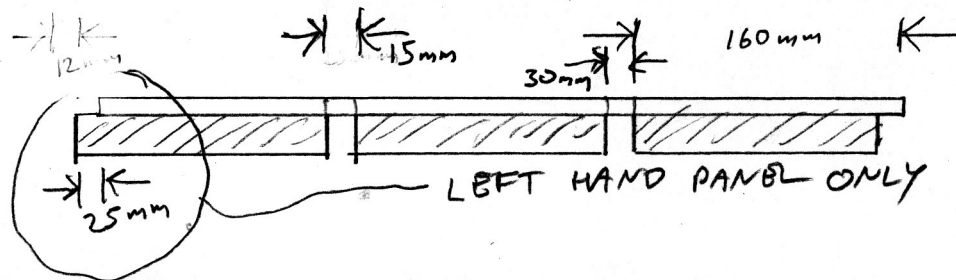

- CEMENT BOARD
- 1 OFF 12 mm BOARD 380 x 2440
- 1 OFF 12 mm BOARD ~140 x 220
- 2 OFF 22 x 160 x 2540 SAWN TREATED
- 2 OFF 100 x 15
- 40 OFF 30mm SCREWS
- 12 OFF 40mm SCREWS TO FIX.

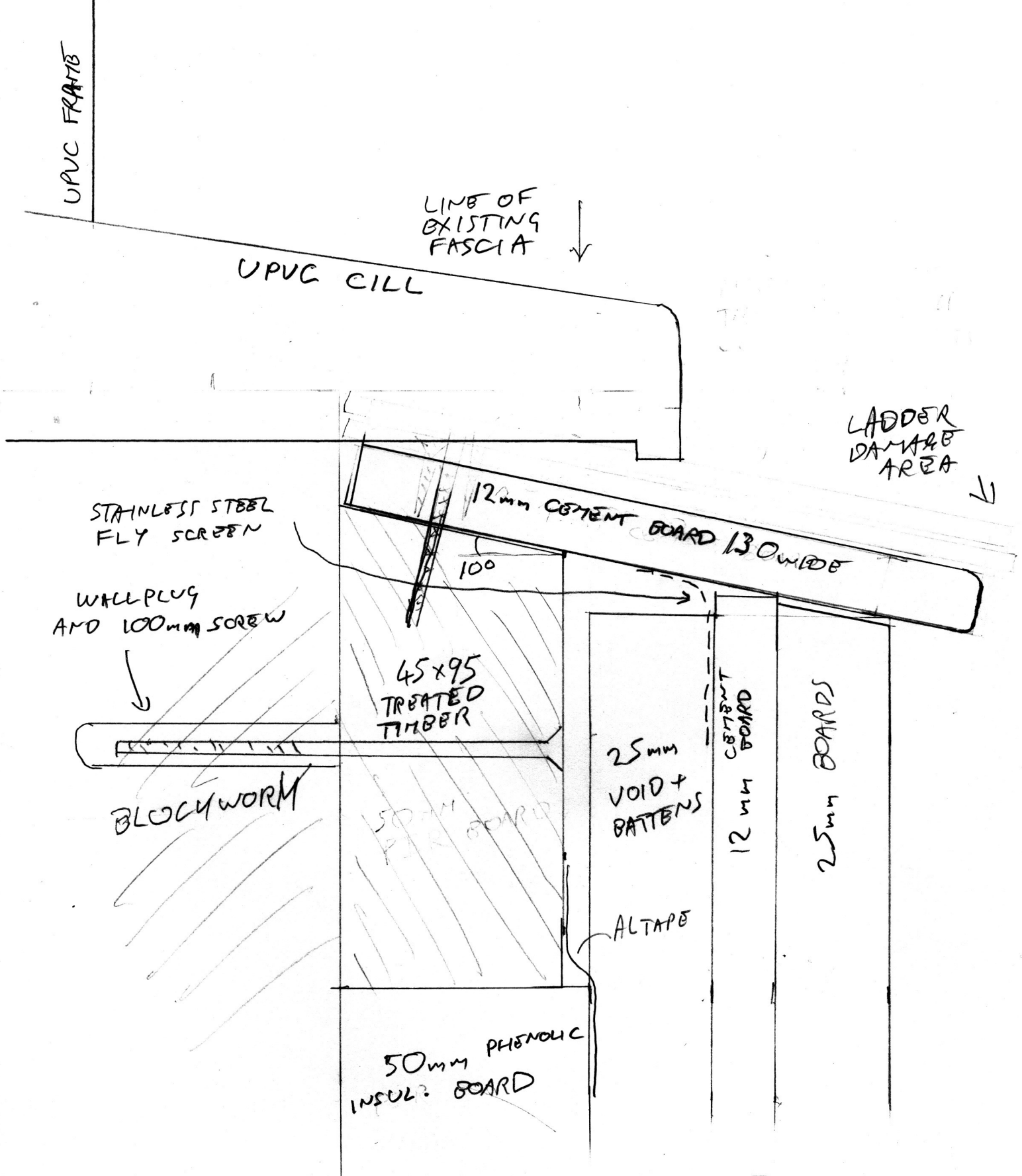

2 CEDAR CHASE  
 WEATHERBOARDS  
 BELOW-WINDOW DETAIL  
 F 26/1/2021  
 VERSION C

NOTE:  
 CILL DETAIL DIFFERS  
 IN OTHER HOUSES.

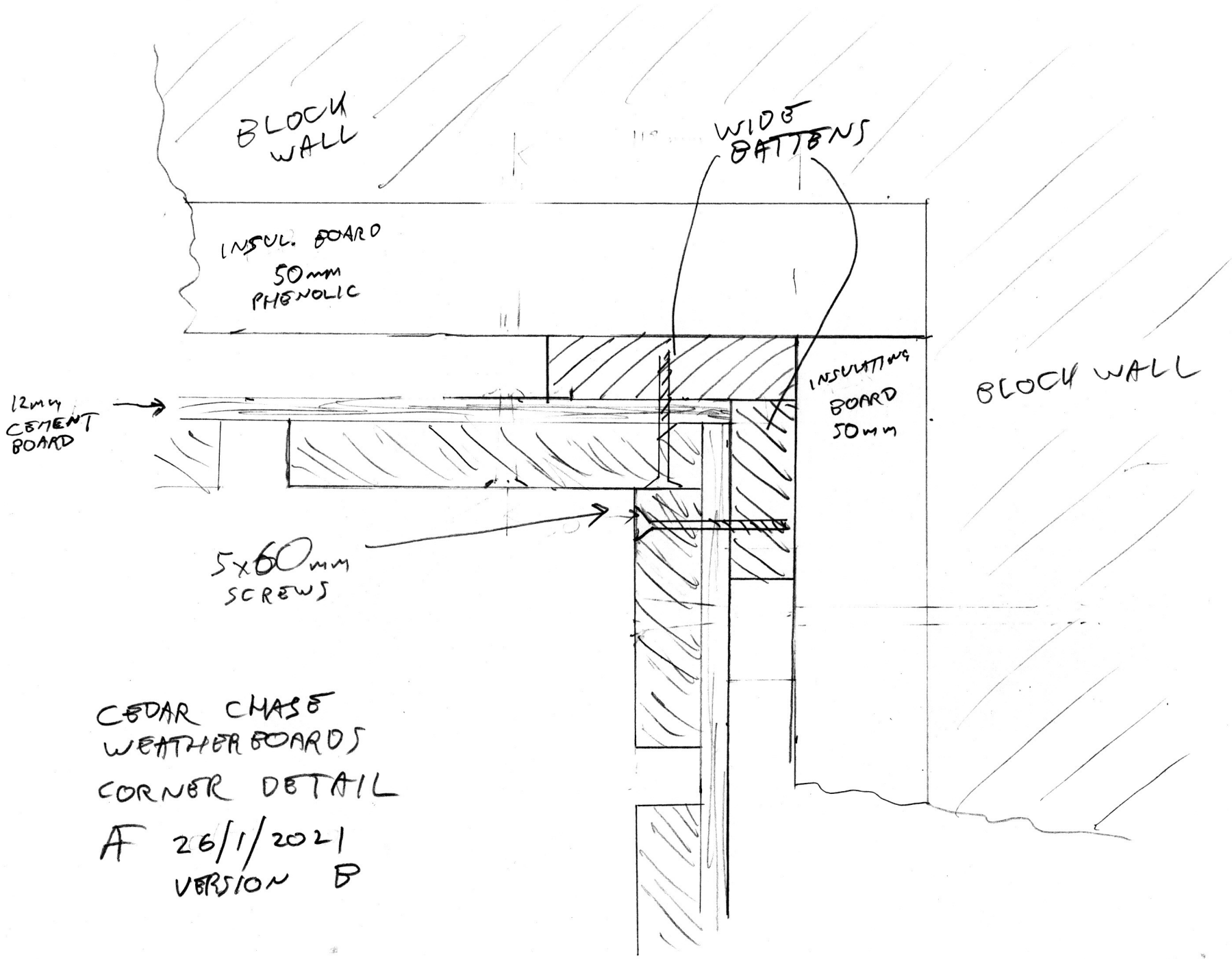

CEDAR CHASE  
WEATHERBOARDS  
CORNER DETAIL  
A 26/1/2021  
VERSION B



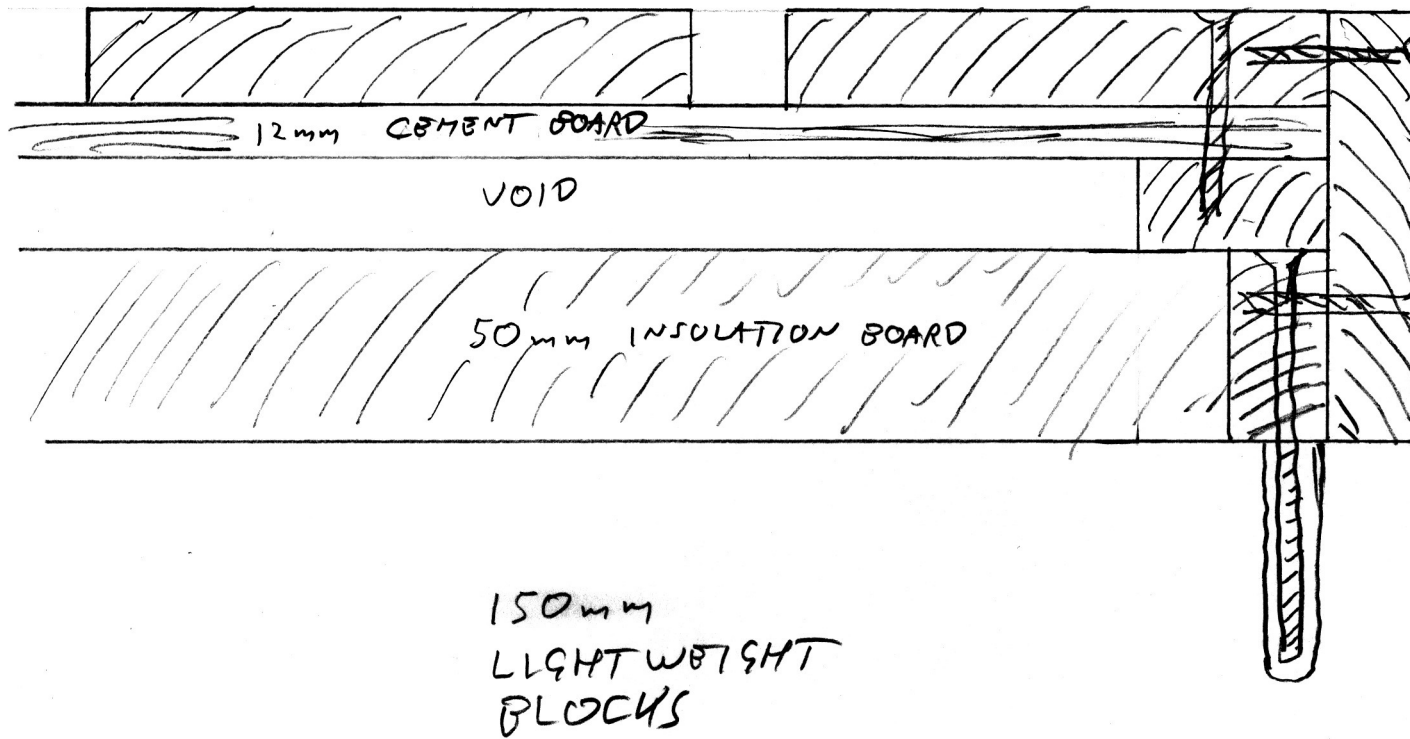

SUPPORT  
FOR  
RAINWATER  
DOWNPIPE

BRICK  
PILLAR

CEDAR CHASE

CLADDING DETAIL : CORNER WITH DOWNPIPE  
PLAN VIEW

A 10/7/2020

CEDAR CHASE WEATHERBOARD REPLACEMENT  
PLAN VIEW OF WINDOW REVEAL DETAIL  
A 26/1/2021  
VERSION B

